

## Pneumatic Operated Multi Disc Clutch

Clutch with pneumatic air supply through the shaft.

For oil operation

- ◆ For working pressure 6 bar, maximal system pressure 10 bar.
- ◆ Possible high duty operation due to wear resistant steel/- steel discs.
- ◆ Compensation of disc wear by self-adjustment.
- ◆ Suited for horizontal mounting.

By the widespread availability of compressed air is the use of these clutches easy to implement.

The pros of this type are the short switching times and the robust construction method.

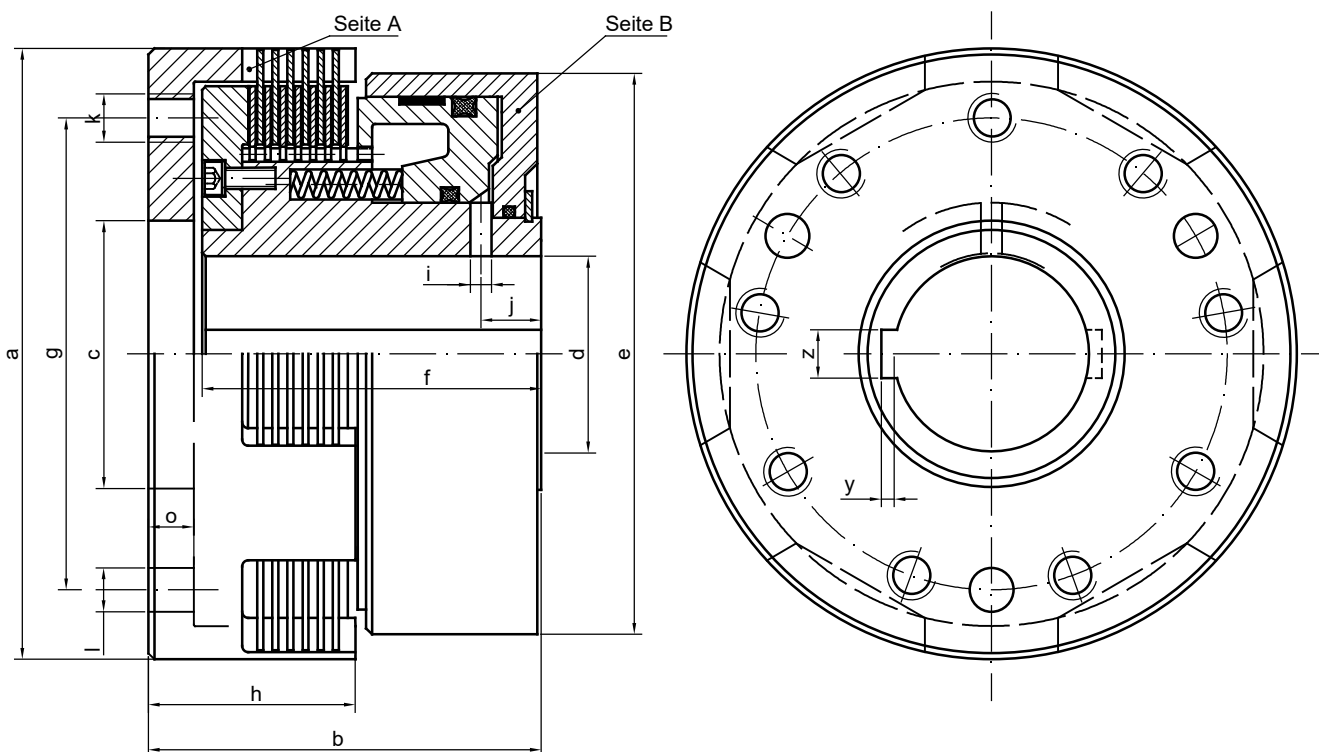

Data and Dimensions		PLW 8	PLW 16	PLW 32	PLW 50	PLW 80	PLW 160	PLW 250
Static torque - 6 bar	Nm	80	180	360	560	900	1800	2800
Dynamic torque - 6 bar	Nm	90	160	320	500	800	1600	2500
Idling torque	Nm	0,04	0,06	0,1	0,2	0,3	0,5	0,8
Friction work per engagement	kJ	2,2	5	10	15	27	52	87
Thermal capacity	W	45	55	72	96	142	200	295
Speed maximum	min <sup>-1</sup>	4000	3850	3650	3500	3200	2900	2400
Stroke volume - discs new / worn	cm <sup>3</sup>	4,5 / 9,5	6 / 12,5	11 / 24	18 / 41	24 / 54	42 / 110	58 / 147
Mass moment of inertia side A	10 <sup>-3</sup> kgm <sup>2</sup>	0,6	1,0	1,9	3,3	9,4	25	59
Mass moment of inertia side B	10 <sup>-3</sup> kgm <sup>2</sup>	1,5	2,0	5,3	10,6	24,3	67,8	155
Mass (weight)	kg	19	22	43	58	97	180	292
Ø a	mm	90	100	115	135	160	200	240
b	mm	57	62	70	80	93	110	135
Ø c H7	mm	40	50	50	60	70	90	105
Ø d H7 max.	mm	30	40	40	50	55	70	85
Ø e	mm	88	95	110	130	155	190	220
f	mm	48	52	60	70	80	95	118
j	mm	13,5	14	14	19,5	20	22,5	27
Ø i	mm	4	4	4	5	6	7	8
h	mm	28	33	42	47	55	67	72
o	mm	8	9	9	9	12	14	15
keyway(s) DIN 6885-1	number	-	1	1	1	2	2	2
	z JS9 x y 1)	mm	8 x 3,3	8 x 3,3	10 x 3,3	12 x 3,3	14 x 3,8	18 x 4,4

1) for d Standard